



38 Ascot Close,
Tividale, B69 1HB

Taylors

38 Ascot Close, Tividale, B69 1HB

*MOST APPEALING & VERY WELL
PROPORTIONED, SEMI-DE-
TACHED RESIDENCE*

- ROOM DIMENSIONS
- GROUND FLOOR
 - Porch
 - Sitting Room - 16' 5" x 13' 4" (5.00m x 4.06m)
- Kitchen Diner - 13' 4" x 9' 9" (4.06m x 2.97m)
- FIRST FLOOR
 - Landing
 - Bedroom 1 - 13' 4" x 9' 1" (4.06m x 2.77m)
 - Bedroom 2 - 11' 2" x 7' 2" (3.40m x 2.18m)
 - Bedroom 3 - 8' 2" x 5' 9" (2.49m x 1.75m)
 - Bathroom - 7' 11" x 5' 10" (2.41m x 1.78m)
- OUTSIDE
 - Driveway
 - Garden
- ALL MEASUREMENTS TAKEN AT WIDEST AVAILABLE POINTS

These particulars are intended only as a guide and must not be relied upon as statement of fact. POTENTIAL BUYERS WOULD ALSO LIKE TO BE REMINDED THAT ALL MEASUREMENTS ARE TAKEN AT THE WIDEST AVAILABLE POINTS. Your attention is drawn to the important notices and disclaimers on the last page of these particulars.



A MOST APPEALING & VERY WELL PROPORTIONED, THREE BEDROOM, SEMI-DETTACHED RESIDENCE pleasantly situated within this POPULAR & ADMIRER CUL-DE-SAC, which has an EXCELLENT RANGE of AMENITIES, TRANSPORT LINKS & SOUGHT AFTER SCHOOLING CLOSE BY. This VERY WELL ARRANGED PROPERTY is perfectly suited for young families or first time buyers and in brief comprises: Porch, Sitting Room, Dining Kitchen, Landing, Three Bedrooms, House Bathroom, Driveway & Rear Garden. EPC: D/ Council Tax Band: B. BHS9683

MISREPRESENTATION ACT 1967

These particulars do not constitute any part of an offer or a contract. Whilst every care is taken to ensure accuracy, no responsibility for errors or misdescription is accepted. Any intending purchaser must satisfy himself by inspection or otherwise as to the correctness of each of the statements in these particulars. The vendor does not make nor give and neither Taylors nor any person in their employment, has any authority to make or give any representation or warranty whatsoever in relation to this property.



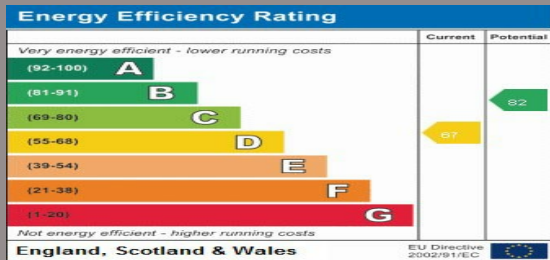

Agents contact details:
 84 to 86 High Street,
 BRIERLEY HILL,
 DY5 3AW
 t. 01384 265265
 f.01384 480824
 e. brierleyhill@taylorsestateagents.co.uk

www.taylorsestateagents.co.uk



Copyright 2015 | Taylors Estate Agents and Surveyors Limited
 Printed by www.stewartdigital.co.uk

Offices at:

KINGSWINFORD HALESOWEN
 STOURBRIDGE BRIERLEY HILL SEDGLEY

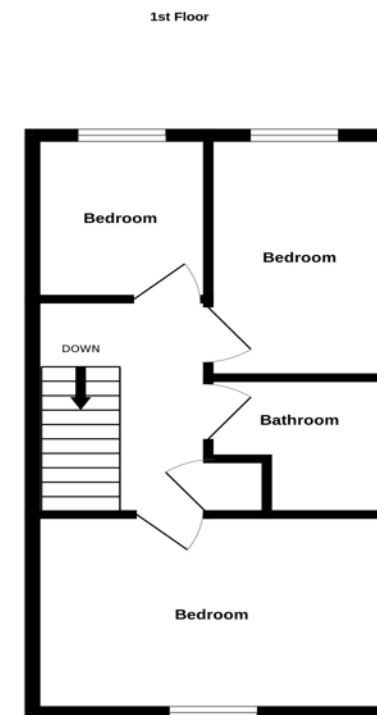
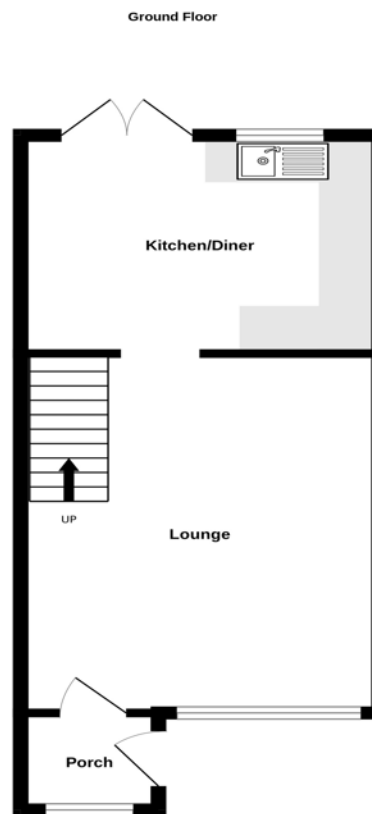

Measurements are approximate. Not to scale. Illustrative purposes only
 Made with Metropix ©2023

GENERAL INFORMATION: As the sellers estate agents we are not surveyors or conveyancing experts and as such we cannot and do not comment on the condition of the property, or issues relating to title or other legal issues that may effect this property, unless we have been made aware of such matters. Interested parties should employ their own professionals to make such enquires before making any transactional decisions. **EPC:** Interested parties may request a copy of the full Energy Performance Certificate (EPC) from any of our offices. Such can be provided free from any charge. **TENURE:** The vendors advise the property is FREEHOLD. Taylors would stress that they have NOT checked the legal documents to verify the status of the property and the buyer is advised to obtain verification from their solicitor or surveyor. **FIXTURES AND FITTINGS:** Only those items specifically mentioned in these sales particulars are included within the sale price. **However, the fitted carpets, curtains, light fittings and other items (if any), whilst not included, are negotiable.** Taylors have NOT tested any apparatus, equipment, fixture or fitting and so cannot verify they are in working order or fit for their purpose. The buyers are advised to obtain verification from their solicitor or surveyor. **PROPERTY MISDESCRIPTIONS ACT 1991:** These particulars have been prepared with care and approved by the vendors (where possible) as correct, but are intended as a guide to the property only, with measurements being approximate and usually the maximum size which may include alcoves, recesses or otherwise as described and you must NOT rely on them for any other purpose. The appearance of an item in any photograph does not mean that it forms part of the property or sale price. Always contact the appropriate Taylors branch for advice or confirmation on any points. **PLANNING PERMISSION/ BUILDING REGULATIONS:** Any reference to the property being extended, altered or converted in any way does not infer that planning permission or building regulations have been granted or applied for, nor do Taylors accept any responsibility for such not having been obtained. Prospective purchasers should always seek verification from their solicitor or surveyor on these aspects. **FLOORPLAN - FOR GUIDE PURPOSES ONLY:** Whilst every attempt has been made to ensure the accuracy of the floor plan contained here, measurements of doors, windows, rooms and any other items are approximate and no responsibility is taken for any error, omission, or mis-statement. This plan is for illustrative purposes only and should be used as such by any prospective purchaser. The services, systems and appliances shown have not been tested and no guarantee as to their operability or efficiency can be given. This floor plan is provided strictly for the purpose of providing a guide and is not intended to be sufficiently accurate for any purpose. Taylors Estate Agents do not accept any responsibility for errors or misuse. Prospective buyers must always seek their own verification of a layout, or seek the advice of their own professional advisors (surveyor or solicitor).